

PICKET POST DRIVER ASSEMBLY DIAGRAM

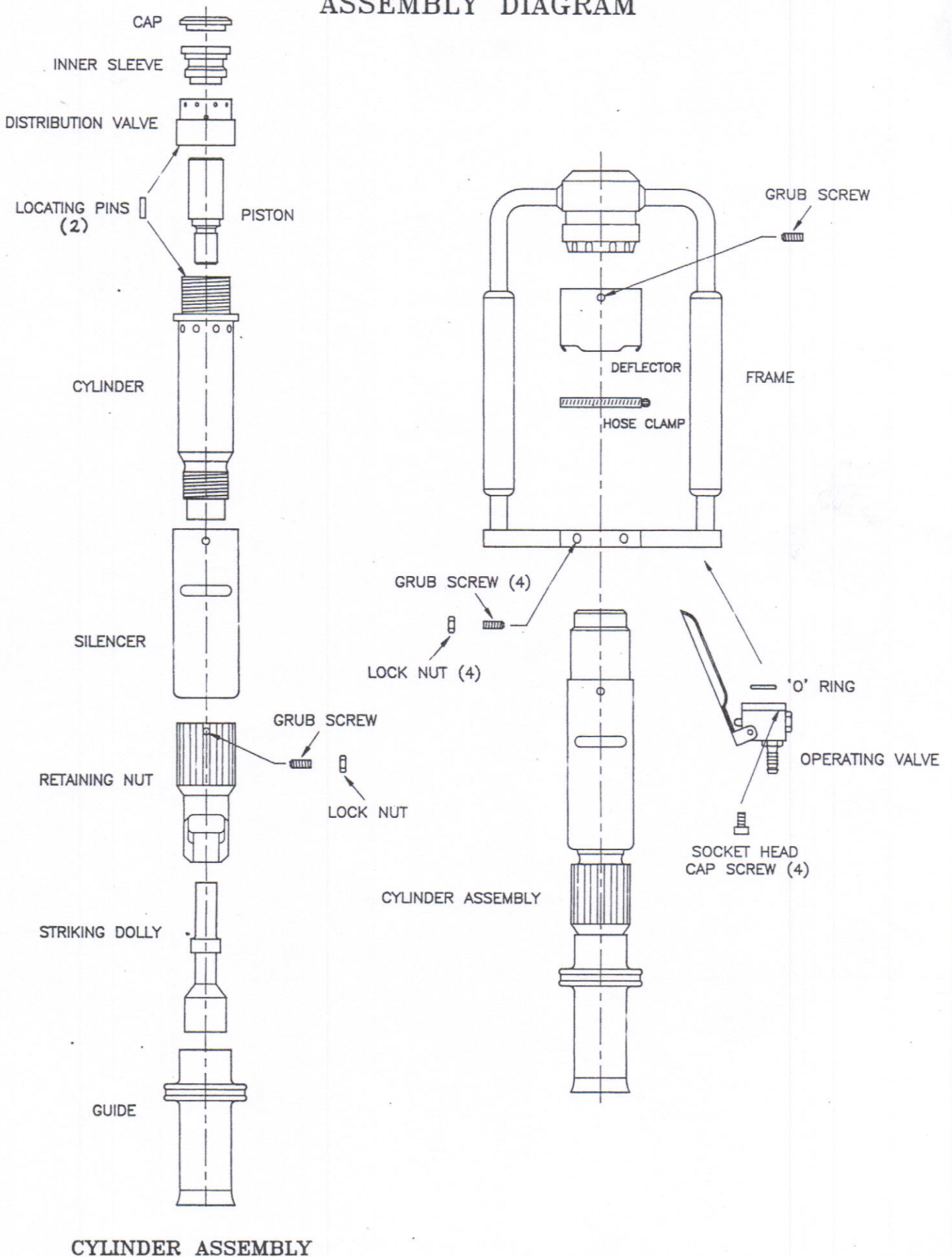

INFORMATION ON DRIVERS & SPARE PARTS.

PICKET POST DRIVER-PPD - 76

Driver comes with a striking dolly in the driver plus spare striking dolly, Quick - release coupling to connect hose to driver & 12mm brass tail to connect hose to compressor, spare grub screws, lock nuts & allenkey. The PPD-76 stands for 76mm opening in frame where various guides are fitted. Maximum size guide to fit the 76 model is 73mm bore ie. maximum size post to be driven is 73mm across corners or diameter. Maximum dolly to fit the 76 is 54mm dia.

Used for driving in star picket post, trellising posts, plastic posts, timber stakes upto 2" square, upto 2" water pipe. To drive 2" water pipe a high tensile plug must be used with 73mm guide. (see spare parts list)

PICKET POST DRIVER - PPD -102

This unit is the same as PPD - 76. The difference being the opening in the frame is 102mm to fit larger sized dolly & larger guides. Guides to fit vary from 54mm bore to 114mm bore. Dolly sizes to fit from 50mm to 74mm.

This Driver is used for more specialised applications e.g. road guide posts, angles, large square posts, & 4" pine posts into pre-augered holes or VERY SOFT ground.

REPLACEMENT STRIKING DOLLY- This will fatigue between 5,000 to 15,000 posts depending on type of ground. Farmers will probably never need another dolly, contractors will break them after continual use.

ADAPTOR DOLLY;- The adaptor dolly has a 25mm hole with six sets of grub screws to hold the tool to be used. This could be a ramming bar, bead breaker, rock breaker, chisel, flat faced tamper for compacting mud bricks & earthen walls. To use the adaptor dolly firstly remove the guide then unscrew the retaining nut & replace the striking dolly with the adaptor dolly. Do not replace the guide.

GUIDES- Guide supplied with PPD -76 is 54mm. Additional guides are 56mm, & 73mm.

PLUGS TO SUIT - 2" & 3" pipe. To be fitted to the top of pipe.

PICKET POST PULLER - Can remove a star post from any sort of ground, including bitumen, without bending the post. The operator can attach the puller to the base of the post without the need to bend down. The puller then works the post out of the ground with a straight vertical action, always working at ground level. A simple mechanical tool, the puller is easily used by anyone, and pays for itself by recovering your posts straight ready to reuse.

PULLER JAW - Same jaw as the puller, to use with chain to tractor / back hoe.

- Hooks around post at any point.

COMPRESSORS - Around the farm - minimum of 17c.f.m. - 5.5hp

-Fencing contractors - 25c.f.m. - 10hp,

-Trellising - 35c.f.m. - 14hp,

- To run tool continuously - 50c.f.m.

AIR HOSE - Minimum of 1/2" MUST BE USED or performance of the driver will be reduced.

OILING

A very light oil should be used. Diesel or 50/50 diesel and oil. If heavy oil or inline oilers are used, it will clog the driver so it will not work properly.

Use 6 drops every 2 hours when in use.