

# *Timberking*

## Operating Manual and Parts List

### PNEUMATIC CHAIN SAW

#### MODEL #'S

Example: TKA017A

(TKA = Timberking Australia, 017 = Average cutting length in inches, A = Aluminium body)

TKA 015A, 017A, 021A, 025A

(Aluminium Body)

TKA 015Z, 017Z, 021Z, 025Z

(Zinc Body)

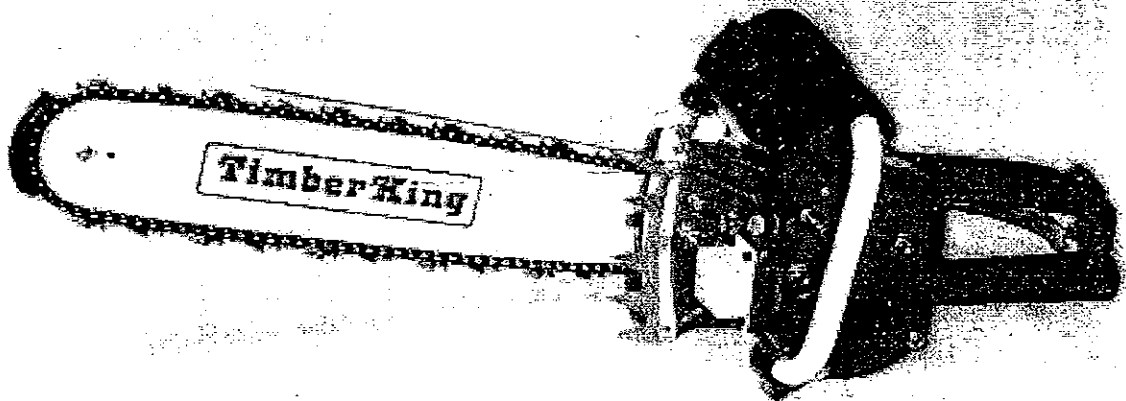

IT IS VERY IMPORTANT THAT YOU READ THIS  
MANUAL BEFORE OPERATING YOUR CHAIN SAW

# **WARNING!**

## **CHAIN SAWS CAN BE DANGEROUS**

**Each year many people are injured in chain saw accidents. Most of these accidents can be avoided. The hands, knees, feet and head are most vulnerable to being cut by the saw chain.**

**If you use a chain saw often, there is also other health risks. The continual noise of the chain saw can lead to permanent hearing loss. Vibration can cause permanent damage to the hands.**

**These hazards mean that chain saws are potentially one of the most dangerous pieces of industrial equipment if not used correctly.**

**With the use of correct protective clothing, and proper work practices, this equipment can be used safely.**

**In the next few pages you'll read valuable information concerning safe chain saw operation. There is a checklist of the safety instructions. Tips on the protective clothing you should wear, and suggestions for safe work methods are provided. Please read on!**

# TIMBERING PNEUMATIC CHAIN SAW

## EXPLODED VIEW

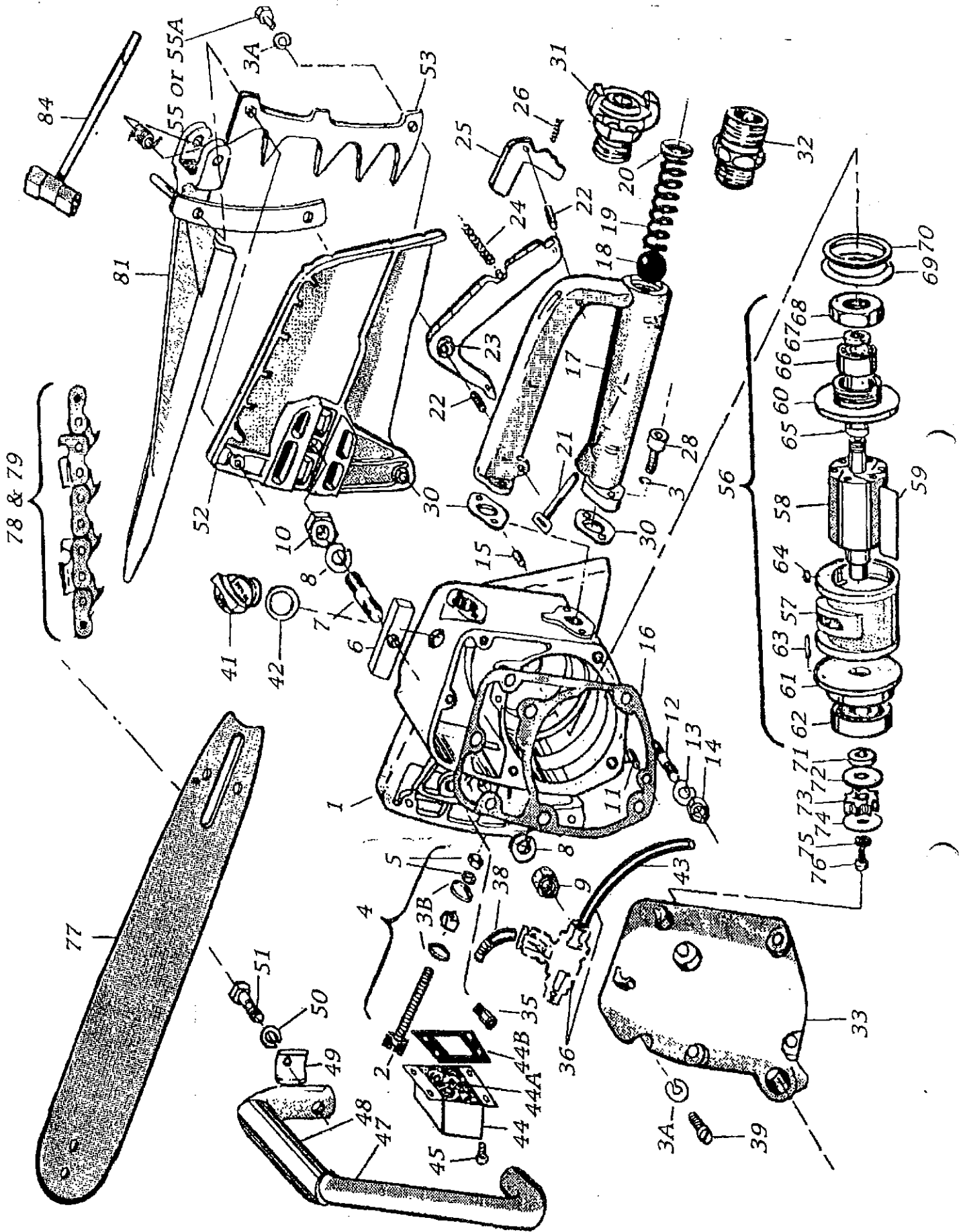

**PART LIST (REF. DRAWING)**

<b>Item</b>	<b>Part No.</b>	<b>Description</b>	<b>Qty</b>
1	TKA 201	Motor Housing – Complete (Items 1 - 16) *	1
2	TKA 202	Screw Fillister Head	1
3	TKA 203	Wave Washer	4
3A	TKA 203A	Spring Washer	5
3B	TKA 203B	Flat Washer	2
4	TKA 204	Chain Stretcher – Complete (Items 2 - 5)	1
5	TKA 205	Hex Plain Nut	2
6	TKA 206	Guide Rail	1
6A	TKA 206A	Guide Rail Pin (Not Illustrated)	2
7	TKA 207	Stud	1
8	TKA 208	Wave Washer	2
9	TKA 209	Hex Nyloc Nut	1
10	TKA 210	Hex Plain Nut	1
11	TKA 211	Seloc Pin	2
12	TKA 212	Stud	4
13	TKA 213	Wave Washer	4
14	TKA 214	Hex Plain Nut	4
15	TKA 215	Grub Screw	1
16	TKA 216	Gasket	1
17	TKA 217	Handle – Complete (Items 17 – 26) *	1
18	TKA 218	Valve Ball	1
19	TKA 219	Pressure Spring	1
20	TKA 220	Spring Retainer	1
21	TKA 221	Throttle Valve	1
22	TKA 222	Seloc Pin	2
23	TKA 223	Throttle Lever	1
24	TKA 224	Pressure Spring	1
25	TKA 225	Safety Lever	1
26	TKA 226	Pressure Spring	1
27			
28	TKA 228	Screw, Cap, Socket Head	4
29			
30	TKA 230	Gasket	2
31	TKA 231	Coupling	Optional
32	TKA 232	Nipple	Optional
33	TKA 233	Oil Tank Cover *	1
34			
35	TKA 235	Pressure Fitting	1
36	TKA 236	Metering Valve – Complete (Items 36 + 43)	1
37			
38	TKA 238	Pressure Line	1

Item	Part No.	Description	Qty
39	TKA 239	Fillister Head Screw	3
40			
41	TKA 241	Screw Plug – Oil Filler	1
42	TKA 242	'O' Ring	1
43	TKA 243	Suction Line	1
44	TKA 244	Silencer – Complete (Items 44, 44A + 44B)	1
44A	TKA 244A	Silencer Filter	1
44B	TKA 244B	Silencer Gasket	1
45	TKA 245	Screw, Cap, Socket Head	4
46			
47	TKA 247	Tubular Handle – Complete (Items 47 + 48)	1
48	TKA 248	Protection Tube Grip	1
49	TKA 249	Stiffening Plate	1
50	TKA 250	Spring Washer	2
51	TKA 251	Hex Screw	1
52	TKA 252	Sprocket Guard	* 1
53	TKA 253	Spike Bar	1
54			
55	TKA 255	Hex Screw (Spike Bar Only)	2
55A	TKA 255A	Hex Screw (With Chain Guard)	Optional
56	TKB 356	Motor – Complete (Items 57 – 68)	1
57	TKB 357	Cylinder Liner	1
58	TKB 358	Rotor	1
59	TKB 359	Vane	6
60	TKB 360	Back Bearing Disc	1
61	TKB 361	Front Bearing Disc	1
62	TKB 362	Bearing	1
63	TKB 363	Cylindrical Pin	1
64	TKB 364	Key	1
65	TKB 365	Spacer	1
66	TKB 366	Bearing	1
67	TKB 367	Notched Locking Nut	1
68	TKB 368	Hex Retaining Nut	1
69	TKB 369	Pressure Ring	1
70	TKB 370	Distance Ring	1
71	TKB 371	Spacer	1
72	TKB 372	Stop Disc	1
73	TKB 373	Chain Drive Sprocket	1
74	TKB 374	Stop Disc	1
75	TKB 375	'Use TKA 250'	1
76	TKB 376	Hex Screw	1

Item	Part No.	Description	Qty
77	TKC 380	15" Guide Bar (Average Cutting Length)	Optional
	TKC 430	17" Guide Bar (Average Cutting Length)	Standard
	TKC 530	21" Guide Bar (Average Cutting Length)	Optional
	TKC 630	25" Guide Bar (Average Cutting Length)	Optional
78	TKC 055	15" Semi-Chisel Chain Loop	Optional
	TKC 061	17" Semi-Chisel Chain Loop	Standard
	TKC 070	21" Semi-Chisel Chain Loop	Optional
	TKC 078	25" Semi-Chisel Chain Loop	Optional
79	TKC 155	15" Tungsten Carbide Chain (Wood)	Optional
	TKC 161	17" Tungsten Carbide Chain (Wood)	Optional
	TKC 170	21" Tungsten Carbide Chain (Wood)	Optional
	TKC 178	25" Tungsten Carbide Chain (Wood)	Optional
	TKC 255	15" Tungsten Carbide Chain (Soft Stone)	Optional
	TKC 261	17" Tungsten Carbide Chain (Soft Stone)	Optional
	TKC 270	21" Tungsten Carbide Chain (Soft Stone)	Optional
	TKC 278	25" Tungsten Carbide Chain (Soft Stone)	Optional
80	TKC 480	Solid Safety Chain Guard (Not Illustrated)	Optional
81	TKC 481	Hinged Safety Chain Guard (Not Illustrated)	Optional
82			
83	TKC 483	Bar Nose Guard SAF-T-TIP (Not Illustrated)	Optional
84	TKC 484	Combination Screwdriver / Wrench	1
85	TKC 485	Front Hand Guard (Not Illustrated)	Optional
86	TKC 486	Underwater Kit (Not Illustrated)	Optional

\*NOTE: THESE PARTS ARE AVAILABLE IN STANDARD 'ALUMINIUM' OR 'ZINC' FOR HAZARDOUS AREA. PLEASE STIPULATE WHEN ORDERING.

THE FRONT HAND GUARD CANNOT BE FITTED UNLESS PART NUMBERS TKC 480 OR TKC 481 ARE FITTED. THESE PARTS ARE OPTIONAL EXTRAS BUT ARE STRONGLY RECOMMENDED AS NECESSARY ITEMS IF THE SAWS ARE TO BE OPERATED BY OTHER THAN EXPERIENCED PERSONNEL.